

PLAN VIEW

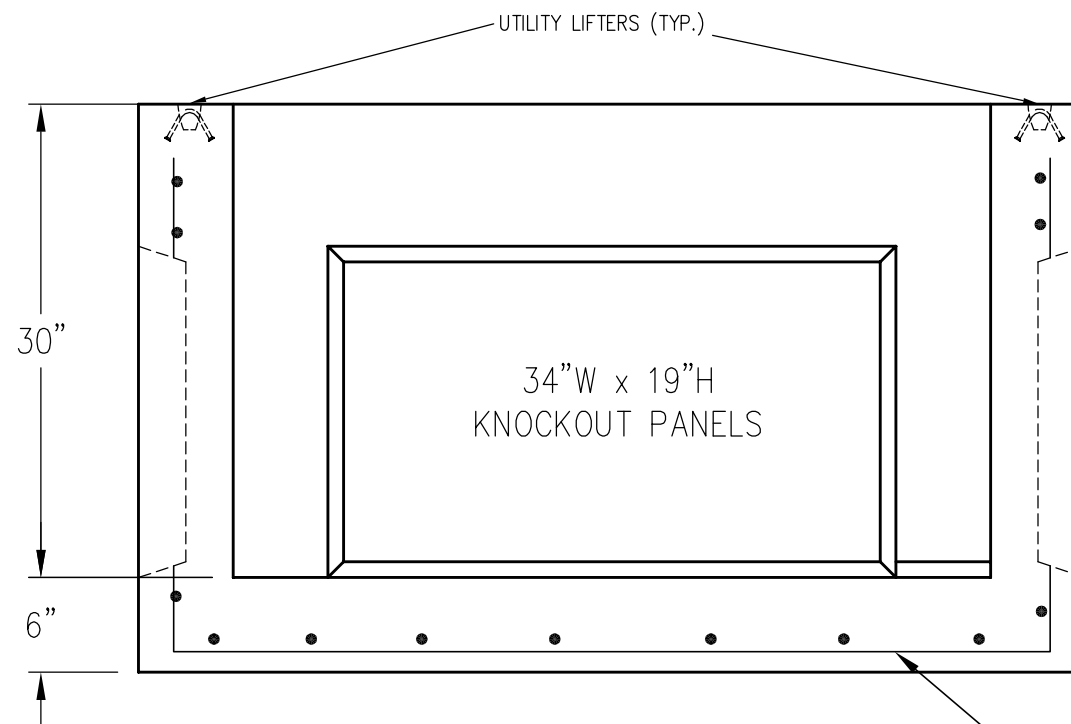

SECTION VIEW

6x6 W4/W4 W.W.M

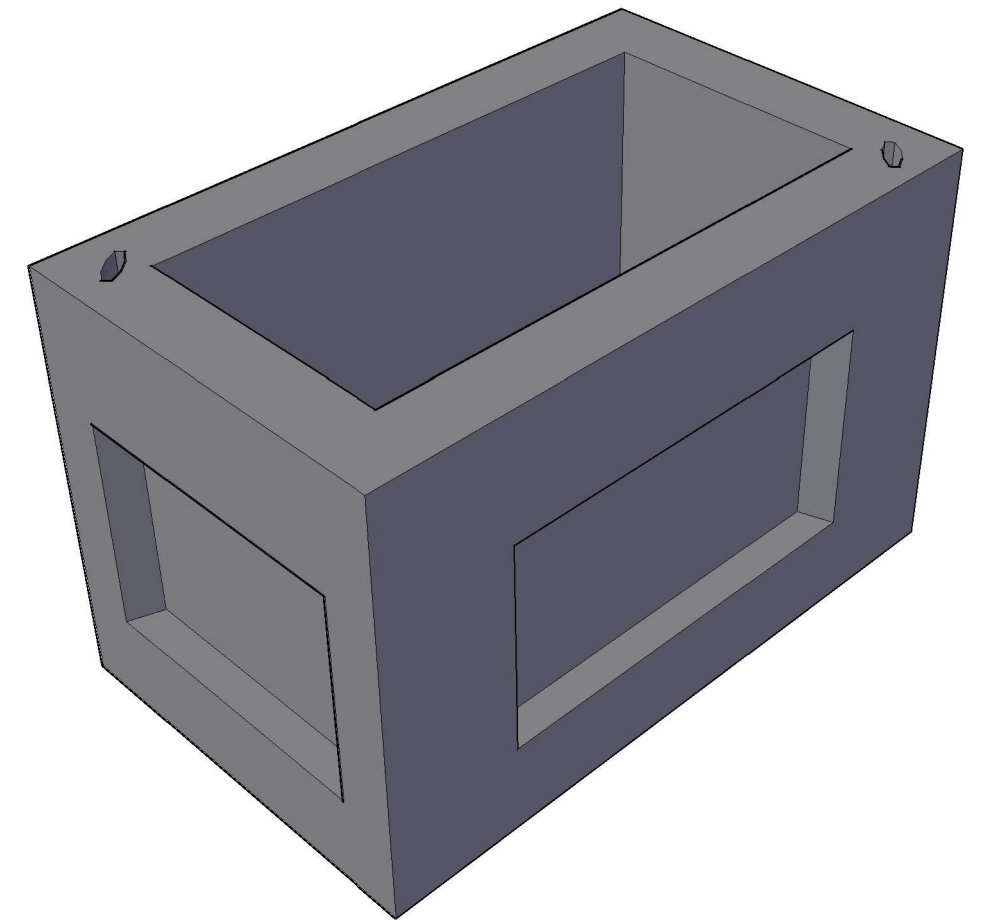

NOTES:

- * CONCRETE TO TEST 5,000 PSI @ 28 DAYS
- * REINFORCING: AS SPECIFIED
- * APPROXIMATE WEIGHT = 3,532 LBS

CONTRACTOR IS RESPONSIBLE FOR SEALING PIPES
PRECAST MANUFACTURING IS NOT RESPONSIBLE FOR WATER TIGHTNESS

**PRECAST MANUFACTURING
CO.**

187 STRYKER ROAD
PHILLIPSBURG, NJ 08865
WWW.PRECASTMFGCO.COM

PHONE: 908-454-2122
FAX: 908-454-0512



THIS DOCUMENT IS THE PROPERTY OF PRECAST MFG. CO. IT IS
CONFIDENTIAL, SUBMITTED FOR REFERENCE PURPOSES ONLY AND
SHALL NOT BE USED IN ANY WAY INJURIOUS TO THE INTERESTS OF,
OR WITHOUT THE WRITTEN PERMISSION OF PRECAST MFG. CO.

**24" x 48" x 30" KNOCKOUT
CATCH BASIN**

REVISION NO.:

DRAWN: PMC

SALES: PMC

DRAWING NUMBER

REV. DATE:

DATE:12/16/2025

CB244830KO