

PLAN VIEW OF PRECAST MANHOLE BASE

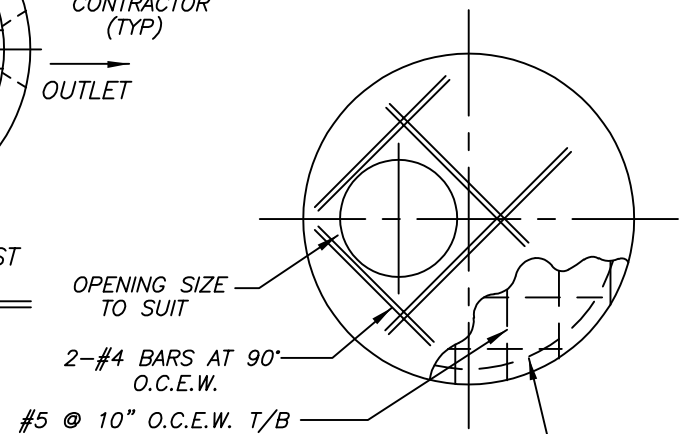

AREA OF CIRCUMFERENTIAL STEEL (SIDE WALLS)  
.24 SQ. IN. PER LIN. FT. (8'-0"Ø)  
.12 SQ. IN. PER LIN. FT. (4'-0"Ø)

REINFORCEMENT LAYOUT FOR 8'-0" DIA MANHOLE FLAT TOP

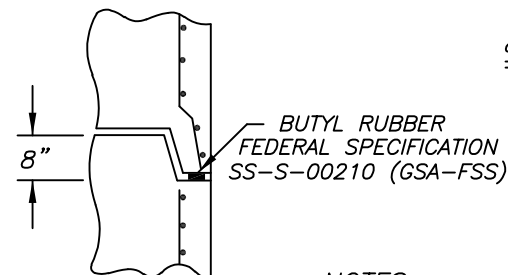

JOINT DETAIL

NOTE:

CONE DIMENSIONS	
DIA OPENING	HEIGHT
24"	36"
30"	36"

NOTES:  
CONCRETE TO TEST 4000 PSI @ 28 DAYS  
IN CONFORMANCE WITH ASTM C-478  
DESIGN FOR H2O LOADING

APPROX. WEIGHTS:

- BASE = 7178 LBS
- RISERS = 3090 LBS/FT
- TOP SLAB = 7469 LBS
- START RING = 6651 LBS

TYPICAL 8'-0" DIA MANHOLE WITH 4' DIA MANHOLE STACK

Precast Manufacturing Co., LLC  
187 Strykers Road Phillipsburg, N.J. 08865  
Tel. (908) 454-2122 - Fax (908) 454-0512

CONT.

JOB

8'-0" DIA CONCRETE MANHOLE  
WITH 48" MANHOLE STACK

DATE

DRAWN BY

DRAWING NO.

1 / 00

CLASSIC DESIGN

3-8-S