

PLAN VIEW OF PRECAST MANHOLE BASE

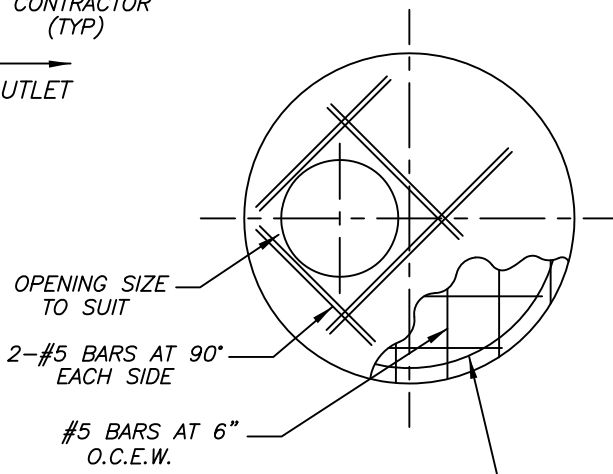

REINFORCEMENT LAYOUT FOR 6'-0" DIA MANHOLE FLAT TOP

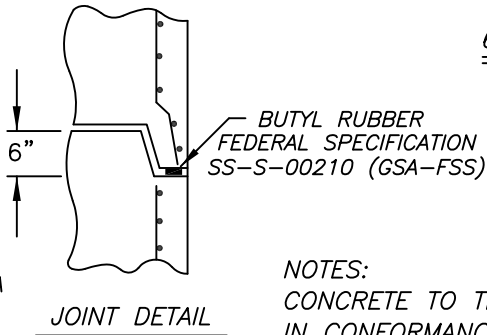

JOINT DETAIL

- APPROX. WEIGHTS:
- BASE = 4724 LBS
  - RISERS = 1800 LBS/FT
  - TOP SLAB = 4864 LBS
  - START RING = 4047 LBS

TYPICAL 6'-0" DIA MANHOLE WITH 4' DIA MANHOLE STACK

NOTE:

CONE DIMENSIONS	
DIA OPENING	HEIGHT
24"	36"
30"	36"

NOTES:  
 CONCRETE TO TEST 4000 PSI @ 28 DAYS  
 IN CONFORMANCE WITH ASTM C-478  
 DESIGN FOR H2O LOADING

Precast Manufacturing Co. , LLC		
187 Strykers Road Phillipsburg , N.J. 08865		
Tel. (908) 454-2122 - Fax (908) 454-0512		
CONT.		
JOB	6'-0" DIA CONCRETE MANHOLE WITH 48" MANHOLE STACK	
DATE	DRAWN BY	DRAWING NO.
1 / 17	CLASSIC DESIGN	3-6-S